



ELGAS

Local. Safe. Reliable
131 161

EasyGas DownUnder™

Award winning design for storing
LPG cylinders underground and
out of sight.



EasyGas DownUnder™

EasyGas DownUnder™ is the first and only underground home LPG supply product, and a popular innovation for homeowners looking for a safe and easy alternative to installing LPG cylinders and equipment adjacent to external walls of their property.

It doesn't matter if you're building a home or renovating, EasyGas DownUnder™ suits new and retro-fit applications. ELGAS work with licensed tradespeople to identify a convenient and compliant location for the installation.

No more visible cylinders or checking gas levels — just hassle free home LPG!

EasyGas DownUnder™ installations are limited to select areas and regions of Australia.

- ✓ Save space with underground cylinders
- ✓ Remote monitoring of usage
- ✓ Reliable, hassle free tanker refills
- ✓ Award winning design
- ✓ Safe and easy installation
- ✓ Unaffected by legislation banning new (mains) natural gas connections



ELGAS

How EasyGas DownUnder™ works

ELGAS works with the homeowner and an ELGAS certified gas fitter to ensure the safe installation of a polyethylene canister and a 90kg cylinder specifically designed for below ground storage and connections.

ELGAS consults with our customers to review their LPG needs as well as the type of appliances being used in the home. Together, we identify the optimal installation and number of LPG cylinders to suit each home. Exclusive remote monitoring of usage and automatic scheduling of tanker refills takes the hassle away from monitoring gas cylinders, switching them over when empty, and ordering replacements.

Your EasyGas DownUnder™ LPG canister and cylinder will be installed as close as practical to the front boundary of your property. The location ensures that installation works are discreet and that our LPG tanker vehicles have safe and easy access.

EasyGas DownUnder™ installations are carried out in two stages. The first stage involves the secure placement of the polyethylene underground canister in a compliant location. The second stage involves the placement of the LPG cylinder, installation of the gas fittings and pipework, and certification of the installation by the licensed gasfitter. Both these stages are completed on the same day.

All EasyGas DownUnder™ installations feature a fire-resistant lid for added safety and will sit flush with your lawn, garden or paddock surface surrounds. An experienced and licensed gasfitter who has been certified by ELGAS will coordinate the installation from start to finish, including a Certificate of Compliance as required under Australian State and/or Territory regulations.

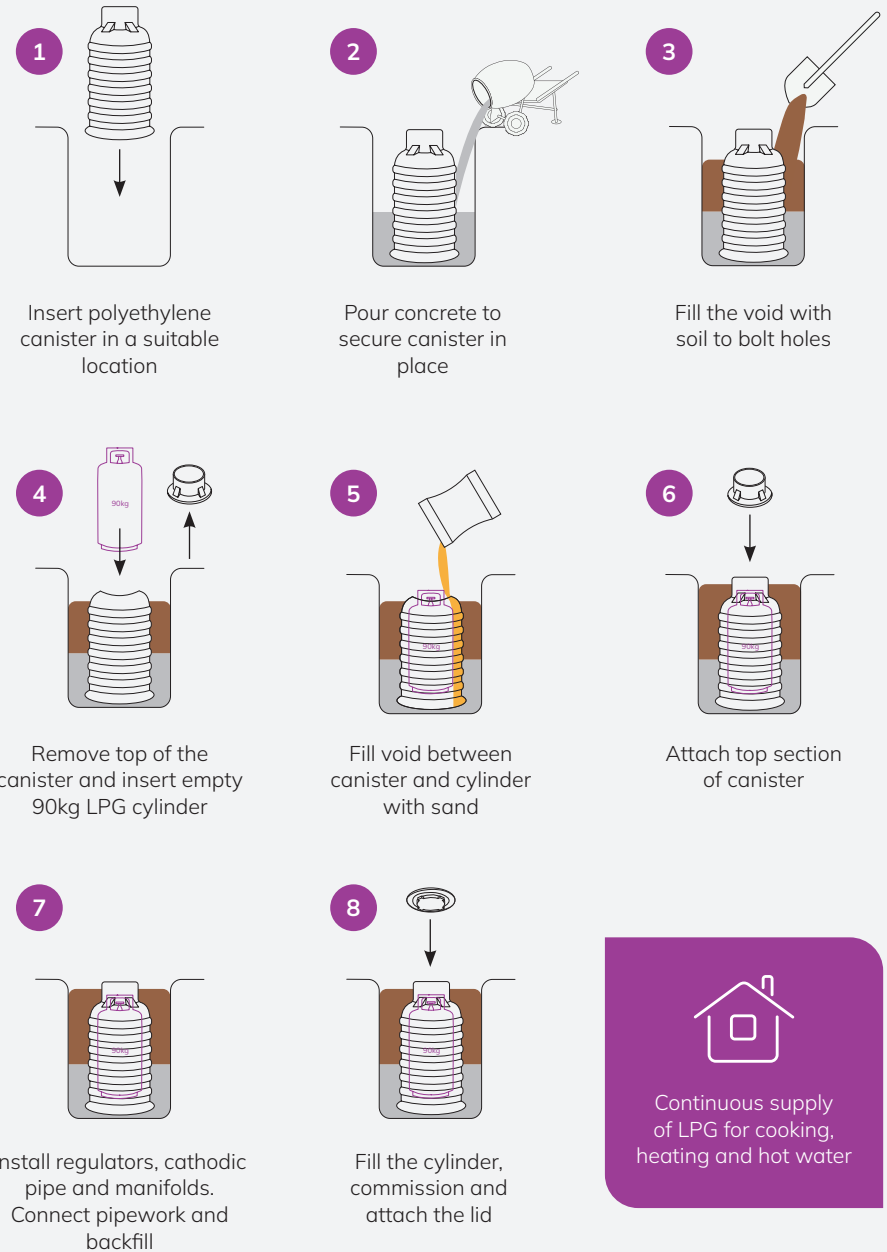

EasyGas DownUnder™ benefits

- ✓ Unaffected by legislation banning new (mains) natural gas connections
- ✓ LPG cylinders are out of sight in a safe and accessible location
- ✓ Take the guess work out of ordering and never run out of gas
- ✓ Fire resistant lid suitable for bush fire prone areas

EasyGas DownUnder™ home owner responsibilities

It is the home owner's responsibility to maintain the area around the underground LPG unit and to report any damage or faults immediately to ELGAS.

- No ignition source or openings (drains, pits etc) within 1.5M of the underground LPG cylinder
- Maintain unobstructed access to the underground LPG unit for tanker refilling
- Do not stand on or drive vehicles/machinery over underground LPG unit
- Do not build or erect any structures above the underground LPG unit
- Remove lid to clear green-matter, spider webs or animal nests every 3 months
- Do not pave or concrete within 0.8m of underground LPG unit
- Keep the area around the underground LPG unit closely cropped and free of water ingress
- The gasfitter will provide a connection point within 1M of the cylinder for the plumber to connect to the appliances

EasyGas DownUnder™ ordering and installation

Contact your local ELGAS team to learn more about EasyGas DownUnder™ as well as our great LPG plans for your home.

[Request a quote](#)



ELGAS